

KITESDER

OPERATOR'S MANUAL

20V BRUSHLESS ANGLE GRINDER

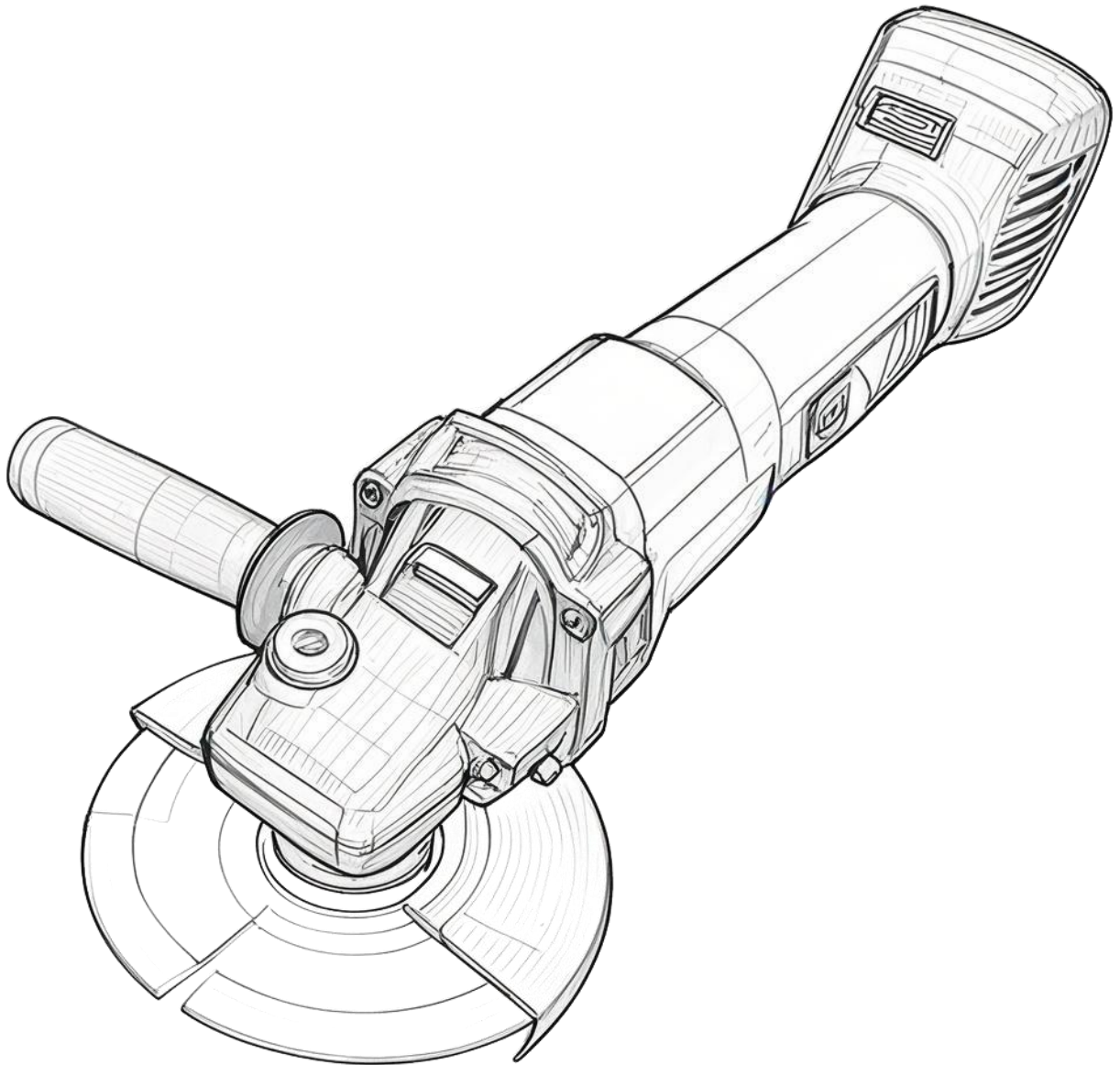

WARNING

Improper or unsafe use of this power tool can lead to death or serious bodily injury! This manual contains crucial product safety information. Read and understand this manual thoroughly before operating the power tool. Ensure this manual is accessible to other users and owners prior to their use of the power tool. Store this manual in a secure location.

GENERAL POWER TOOL SAFETY WARNINGS

⚠️ WARNING Read all warnings and all instructions. Failure to follow the warnings and instructions below may result in electric shock, fire and/or serious injury. Keep all warnings and instructions for future reference. In all the following warnings, the term "power tool" refers to a mains-operated (corded) power tool.

Safety in the Workplace

1. Keep the workplace clean and well-lit. A cluttered and dark workplace can cause accidents. Avoid direct contact of your body with grounded surfaces, such as pipes, radiators, and refrigerators. If your body is grounded, it will increase the risk of electric shock.
2. Do not operate power tools in explosive environments, such as those with flammable liquids, gases, or dust. The sparks generated by power tools can ignite the dust or gas, posing a risk of electric shock.
3. Operate power tools only after keeping children and bystanders away. Lack of concentration can cause the operator to lose control of the tool.

Electrical Safety

4. The battery pack of the power tool must be compatible with the machine. Never modify the battery pack in any way, and for power tools that require grounding, do not use any conversion plugs. An unmodified battery pack and the compatible machine will reduce the risk of electric shock.
5. Avoid direct contact of your body with grounded surfaces, such as pipes, radiators, and refrigerators. If your body is grounded, it will increase the risk of electric shock.
6. Do not expose power tools to rain or a wet environment. Water entering the power tool will increase the risk of electric shock.
7. Do not abuse the battery pack. Never handle the power tool and its battery pack roughly, or deliberately knock them. Keep the battery pack away from heat sources, oil, sharp edges, or moving parts. A damaged battery pack will increase the risk of electric shock.
8. When using power tools outdoors, use lithium-ion battery-powered tools suitable for outdoor use, which can reduce the risk of electric shock.
9. If it is inevitable to operate power tools in a wet environment, use a Residual Current Device (RCD). Using an RCD can reduce the risk of electric shock.

Personal Safety

1. Stay alert, focus on the operation you are performing when operating power tools, and keep a clear mind. Do not operate power tools when you are feeling tired, or under the influence of drugs, alcohol, or the effects of treatment. A momentary distraction while operating power tools can lead to serious personal injury.
2. Use personal protective equipment. Always wear safety goggles. Safety devices such as dust masks under appropriate conditions, non-slip safety shoes, safety helmets, hearing protection devices, etc. can reduce personal injury.
3. Prevent accidental starting. Ensure that the switch is in the off position when connecting the power source and/or battery pack, picking up or carrying the tool. Placing your finger on the switched-on power switch or inserting the plug when the switch is on may lead to danger.
4. Before turning on the power tool, remove all adjustment keys or wrenches. A wrench or key left on the rotating parts of the power tool can cause personal injury.
5. Do not stretch your hands too far, and always pay attention to your footing and body balance. This allows you to control the power tool well in case of an unexpected situation.
6. Dress appropriately. Do not wear loose clothing or accessories. Keep your clothes, gloves, and hair away from moving parts. Loose clothing, accessories, or long hair may get caught in the moving parts.
7. If devices for connecting to a chip removal device or dust collection equipment are provided, make sure they are properly connected and used. Using these devices can reduce the risks caused by dust and debris.

GENERAL POWER TOOL SAFETY WARNINGS

Personal Safety

1. Do not abuse power tools. Use the appropriate power tool according to its intended purpose. Selecting a power tool properly designed for the task will make your work more efficient and safer.
2. If the switch cannot turn the power of the tool on or off, do not use this power tool. A power tool whose switch cannot control it is dangerous and must be repaired.
3. Before making any adjustments, changing accessories, or storing the power tool, be sure to unplug the plug from the power source and/or disconnect the battery pack from the tool. This protective measure will reduce the risk of accidental starting of the tool.
4. Store unused power tools out of the reach of children, and do not let people who are unfamiliar with power tools or do not understand these instructions operate the power tools. Power tools are dangerous in the hands of untrained users.
5. Maintain power tools. Check whether the moving parts are properly adjusted or jammed, and inspect for damaged parts and other conditions that may affect the operation of the power tool. If there is any damage, the power tool should be repaired before use. Many accidents are caused by poorly maintained power tools.
6. Keep the tools sharp and clean. A well-maintained tool with a sharp edge is less likely to get stuck and is easier to control.
7. Use power tools, accessories, and tool bits, etc. in accordance with the instruction manual, taking into account the working conditions and the tasks being performed. Using power tools for operations that are not in line with their intended purposes may lead to danger.

Maintenance

1. Send your power tool to a professional repairman and have it repaired using the same spare parts. This will ensure the safety of the repaired power tool.
2. If the power supply flexible cord must be replaced, in order to avoid danger, it must be replaced by the manufacturer or the agent.

GRINDER SAFETY WARNINGS

⚠️ WARNING This appliance is not intended for use by persons, including children, who have reduced physical, sensory, or mental capabilities, or lack experience and knowledge. Such individuals should not use the appliance unless they are under the supervision or have received instruction regarding its use from a person responsible for their safety.

Always assume that the tool is loaded with fasteners. Careless handling of the stapler or nailer can lead to the unexpected firing of fasteners, which may cause personal injury.

- Never point the tool at yourself or anyone in the vicinity. An accidental trigger pull can discharge the fastener and result in an injury.
- Do not activate the tool unless it is firmly pressed against the workpiece. If the tool is not in contact with the workpiece, the fastener may be deflected and miss the intended target.
- Do not use this stapler or nailer to fasten electric cables. It is not designed for electric cable installation and may damage the insulation of the cables, potentially leading to electric shock or fire hazards.
- Always use both hands to operate the tool. Your non - dominant hand should be used to firmly press the back of the tool down onto the surface to be fastened.

Supplementary Safety Rules for Battery Packs

1. Before performing any work (such as changing tools, inspection, maintenance, handling, storage, etc.), the forward/reverse switch slider must be set to (switch locked) and then the battery pack should be removed.
2. Before using the machine, it is necessary to check whether the battery pack is properly installed.
3. It is prohibited to charge a damaged battery pack.
4. After charging is completed, please turn off the power supply first, and then remove the battery pack from the charger. Do not leave the battery pack in the charger for a long time.
5. When the machine is not in use, do not insert the charged battery pack into the charger.
6. Do not attempt to disassemble the battery pack. When maintenance or repair is required, it should be handed over to professional maintenance personnel. Incorrect assembly poses a risk of electric shock or fire.
7. It is prohibited to short-circuit the battery pack.
8. It is prohibited to throw the battery pack into a fire, as it will pose an explosion hazard.
9. It is prohibited to drop, vibrate or impact the battery pack.
10. When charging, the battery pack will become slightly warm, which is a normal phenomenon.
11. Do not use the battery pack as a hammer. Striking may cause an accidental short - circuit, fire or even explosion.
12. The battery pack must be kept away from high temperatures or flames! Do not place the battery pack on a heater, nor expose it to strong sunlight. Excessive temperature poses an explosion hazard.
13. The workplace must be well - ventilated. Toxic gases emitted by battery packs that are not used as required or are damaged can cause personal injury.
14. The battery pack may leak when it is over - heated or over - used. If the leakage contaminates the machine parts, please clean these parts and replace the contaminated parts if necessary. Do not use the battery pack with leakage anymore. If the leakage gets on your skin accidentally, first wash it with soap, then with lemon juice or vinegar. If the leakage gets into your eyes, immediately rinse them with clean water and go to the hospital for a check - up and treatment. The liquid splashed from the battery pack may cause corrosion or combustion.
15. The battery pack needs to be protected from moisture and mildew. It is prohibited to get it wet or let it be exposed to rain.
16. If the battery is not used for a long time, please charge and discharge it once every two months and then fully charge it for storage.
17. The ambient temperature for storing the battery pack ranges from 0 to 45 °C. If the ambient temperature is too high or too low during storage, the battery pack's capacity will be affected.
18. The battery pack contains lithium - ion active substances. The activity of lithium - ions varies at different temperatures, so the usage time in winter will be shortened.
19. Avoid placing the battery pack near other metal objects, such as paper clips, coins, keys, nails, screws, or other small metal parts, because metal objects may cause the battery pack to be electrically connected. A short - circuit of the battery pack can cause sparks, burns, or explosion and fire.
20. Do not discard used battery packs in general household waste, flames, or water. Please collect damaged battery packs and send them to a recycling center.
21. Do not charge the battery when the indoor temperature is below 10°C or above 50°C. Charging may not be possible when the room temperature is below 0°C.
22. When charging, it is strictly prohibited to place the battery pack charger on flammable objects such as beds or sofas. It is advisable to place it on objects like tiled floors or concrete floors.
23. During the charging process, please have a dedicated person keep an eye on it, and over - charging is strictly prohibited.

About Angle Grinder

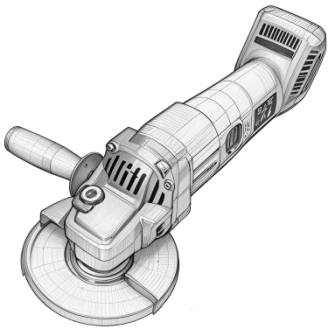
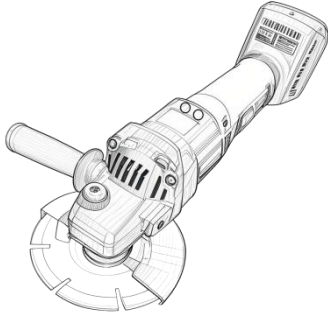
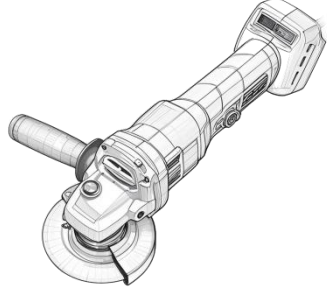
			
Model No:	JMJ20V-C05-1	JMJ20V-C05-2	JMJ20V-L205
Rated Voltage:	20V	20V	20V
No-load Speed:	0-9000r/min	0-9000r/min	0-9000r/min
Motor power	500W-600W	500W-600W	500W-600W
Diameter of grinder wheel disc	Φ 100mm	Φ 100mm	Φ 100mm
Feature	1.Brushless motor 2.Three-speed rotation adjustment	1.Brushless motor 2.Three-speed rotation adjustment 3.Digital display screen	1.Brushless upgraded motor 2.Three-speed rotation adjustment

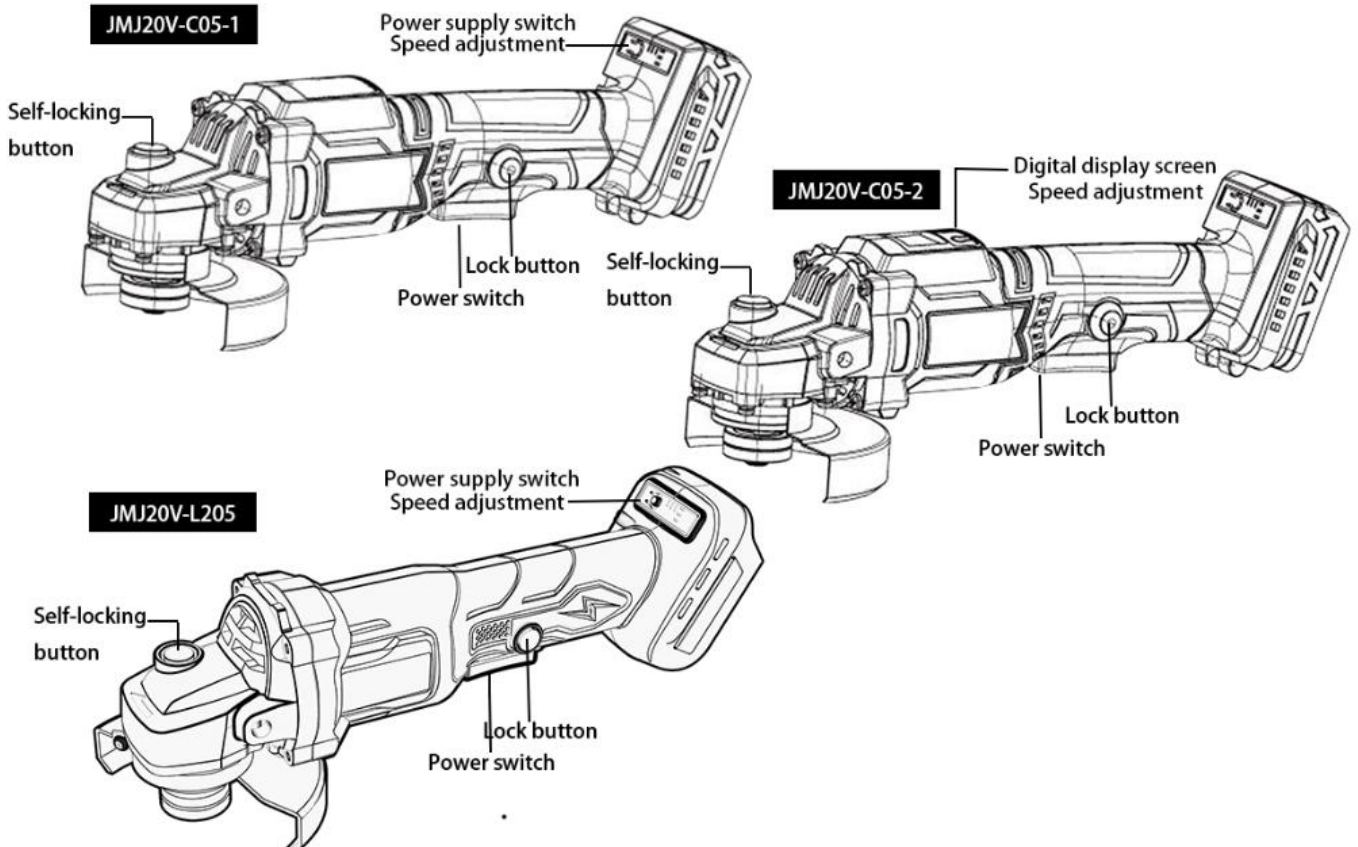

Safety Instructions for Using Angle Grinder

1. Always wear safety goggles and ear protection when performing processing. At the same time, other labor protection supplies such as dust masks, gloves, safety helmets, and aprons should be used.
2. Keep the protective cover in the fixed position.
3. Only use the correct grinding wheel, and its maximum operating speed should not be lower than the highest "no-load speed" marked on the tool nameplate. When using a grinding wheel, only use a fiberglass-reinforced grinding wheel. Do not use a grinding wheel disc with a maximum rotational speed lower than 80m/s.
4. Carefully check whether the grinding wheel has cracks and damage before operation. If there are cracks or damage, replace the grinding wheel with a new one immediately.
5. Follow the requirements in the instruction manual to correctly install and use the grinding wheel. The grinding wheel should be handled with care and stored properly.
6. Do not use reducing bushings or connectors to modify large-aperture grinding wheels. Only use the special flange for this tool.
7. Do not damage the spindle, flange (especially the installation surface) or lock nut. Otherwise, the grinding wheel disc itself will also be damaged. For tools using grinding wheels with threaded holes, ensure that the threads of the grinding wheel are long enough to fit onto the spindle.
8. Before using this tool for actual workpiece operation, run the tool at the highest no-load speed for 30 seconds at a safe location. If the tool vibrates or wobbles due to poor assembly or eccentric imbalance of the grinding wheel, stop the operation immediately. Check whether the workpiece is fixed.
9. Hold the tool firmly.
10. Keep your hands away from the rotating parts.
11. Make sure that the grinding wheel and the workpiece are not in contact with each other before turning on the switch.

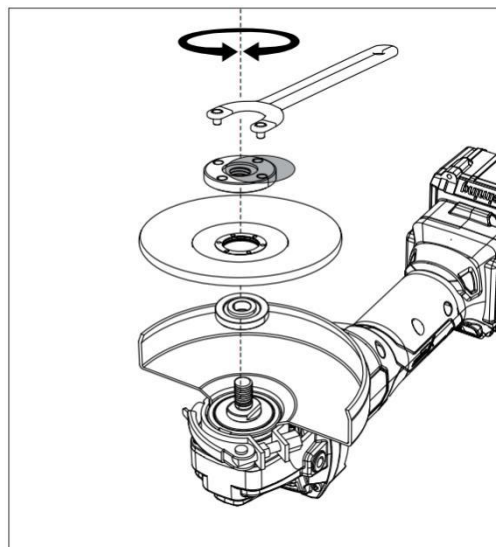
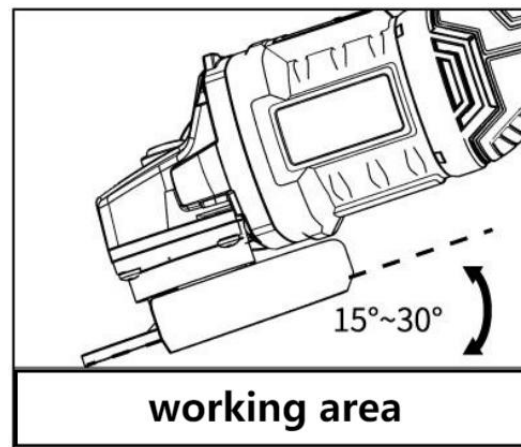
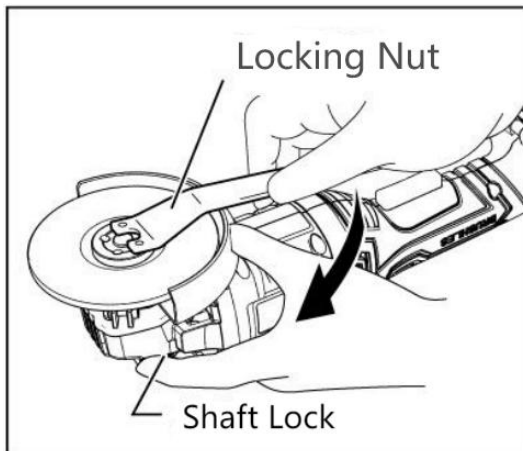

Speed Regulation Of Angle Grinder

Digital display model

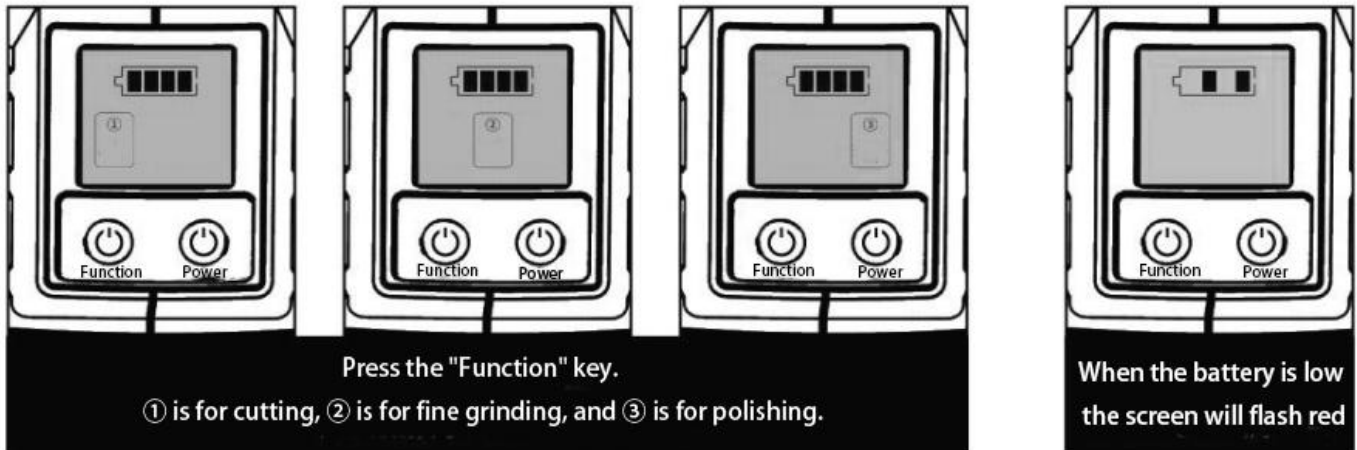

Non-Digital display

