

Installation
Manuals

AB COASTER



Please read the manual carefully and keep it properly
before installing and using this product

Maintenance & Repair

Cleaning

Do not use steel pads, gasolie or acetone abrasive cleaners or corrosive cleaning products on any parts.

Do not use wet cloth or detergent to clean.

Keep out of water.

Proper cleaning method:

Clean the watch head and frame with a dry cloth.

After use

1. Keep clean.
2. Stay away from sunlight or high temperature and humidity.
3. Do not allow children to use the product as a toy.

Safety Warning

Please read this section carefully before you learn how to operate the product correctly.

The contents listed below are important for proper operation of the product to prevent accidental injuries to users.

Please keep this manual handy for reference.

Note: consult your doctor before starting an exercise program. This is especially important for adults age 35 or older or those with previous health problems.

Please read all installation manuals carefully before use.

Important safety instructions

1. Stop immediately if you feel nausea, dizziness or pain during exercise.
2. Please check whether the product is damaged or the parts are loose or come off before use.
3. Do not wear loose clothing when using the product.
4. Suitable athletic footwear must be worn when using the product.
5. Do not support the physical, sensory organs damaged, mental incomplete use with caution.
6. Children should be accompanied by their guardians.
7. Please ensure that children do not use this product as a toy.
8. Place the product on a smooth surface for use.
9. The product needs to have enough safe space.
10. Hands and feet must avoid moving parts.
11. Install the product according to the installation instructions.
12. Please make sure the product is stable before use.
13. Please fold first when moving the product use the roller to move.
14. Do not place the product in a damp place.
15. The maximum working load shall not exceed **140KG**.

Product Use



1. initial position



2. Pull the body into the frame



3. Pull it to the top and then relax

Product Introduction

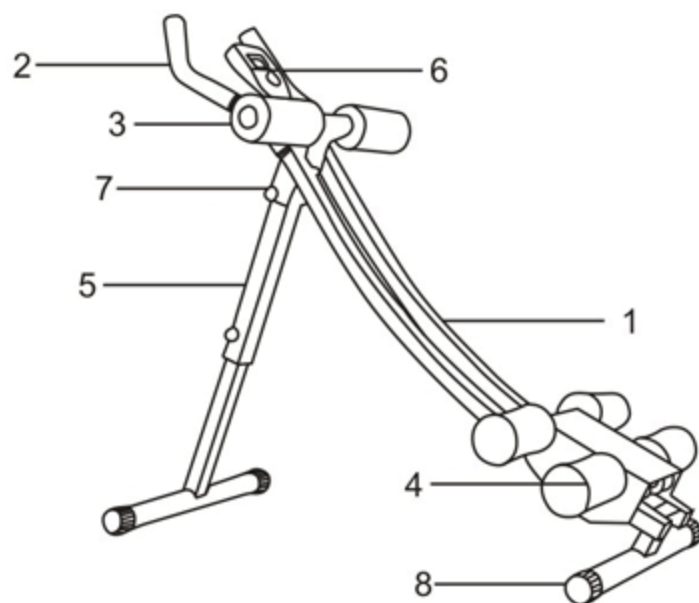

- 1. Main Frame
- 2. U-Handlebar
- 3. Handlebar Foam
- 4. Foam covering I-Shape
- 5. Support Frame
- 6. Monitor
- 7. Bolt
- 8. Non-slip Covers

Product Install

First

According to the assembly diagram.
Mke sure installation firmly.

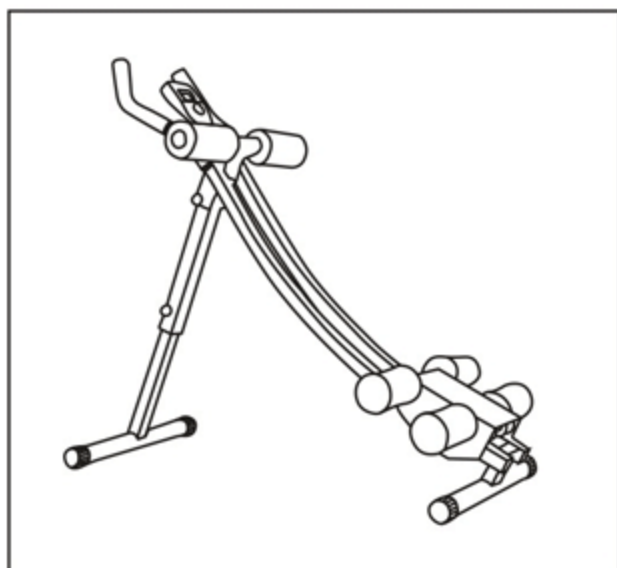

Second

Install the monitor onto the handlebar.
Connect the monitor line.

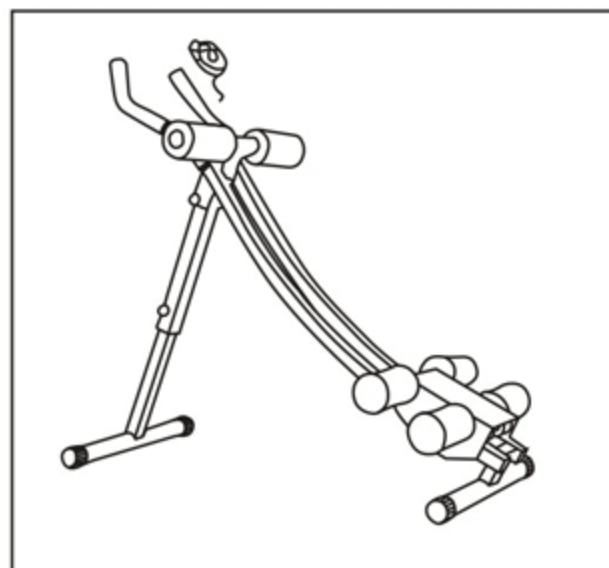

Product Install

Fold the product

Pull the safety bolt out.

Fold the product as shown in pictures A and B.

Insert the safety bolt into the frame hole.

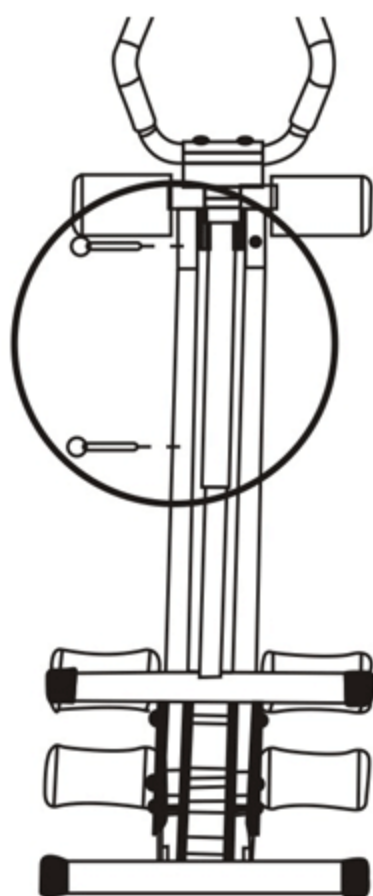

A

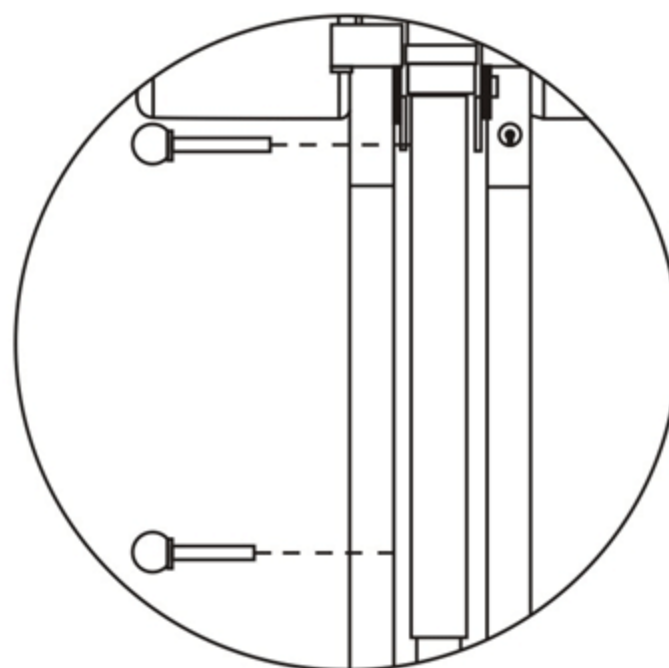

B

Problem Solve

The following are the most common product problems.
If the following information cannot immediately solve your problem,
Please contact the dealer.

| | |
|--|--|
| | |
| Missing Parts | <ol style="list-style-type: none">1. Check the packing box.2. Contact the dealer. |
| No Record Data When Sport | <ol style="list-style-type: none">1. The induction wire is broken.2. The induction magnet dropped.3. Try adjusting the installation first. |
| No-Display Monitor | <ol style="list-style-type: none">1. Reinstall the battery or replace a new one. Pay attention to the positive and negative electrodes.2. The induction wire is broken. |
| The small screw won't fit | Let the iron sheet close to the lid before turning the screw. |
| The hole position is not in line by main frame and support frame | Reinstall the screws on the side. |

Please contact with dealer if you have any questions.